

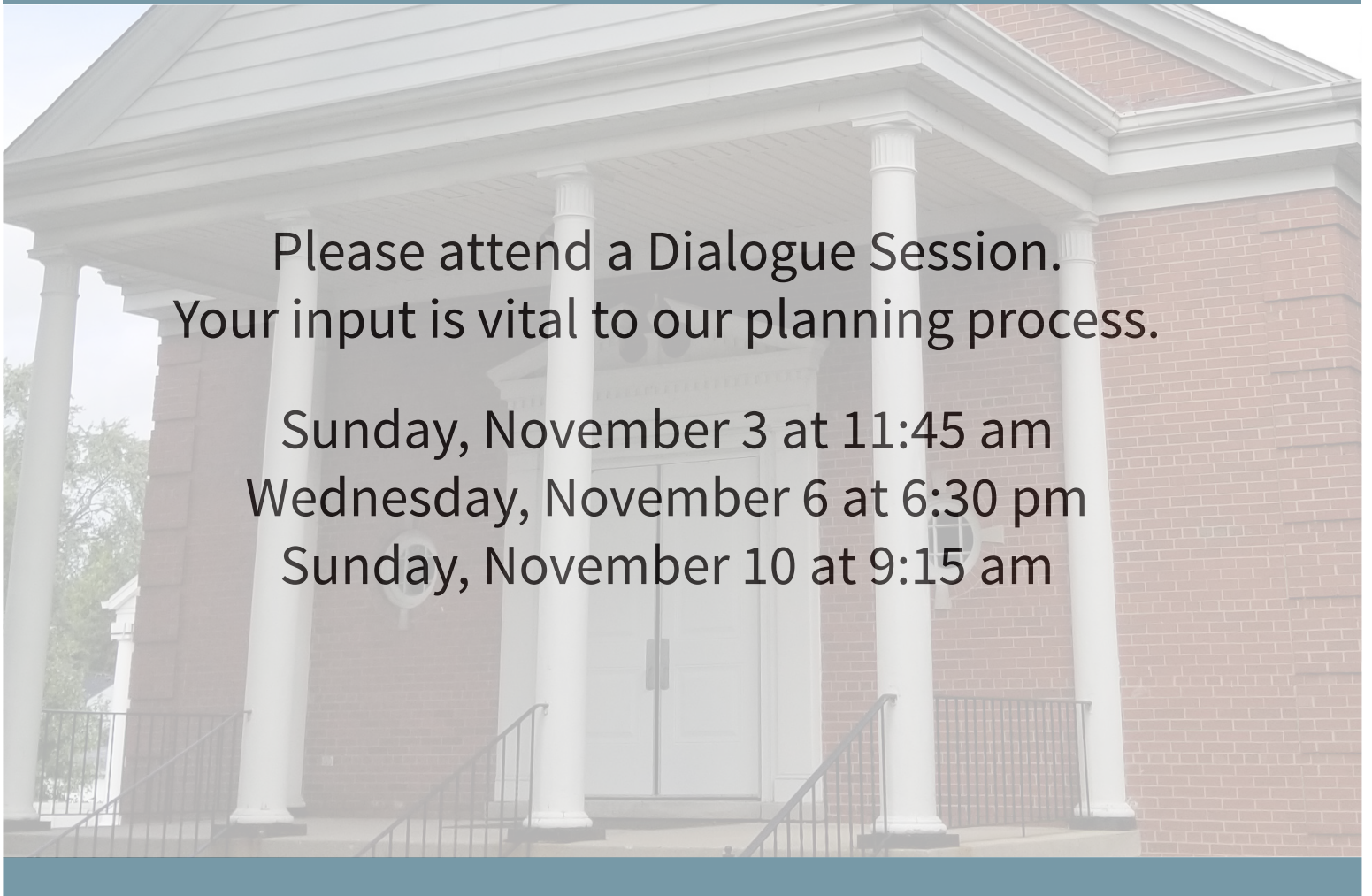

Preliminary Building Plans & Proposed Capital Campaign

Please attend a Dialogue Session.
Your input is vital to our planning process.

Sunday, November 3 at 11:45 am
Wednesday, November 6 at 6:30 pm
Sunday, November 10 at 9:15 am





Loved by God, we grow, care, give, and share in Jesus' name.

Dear Friends,

St. Paul is alive in God's Spirit! We are an enthusiastic community that welcomes all to Christ. We **SHARE** our faith and resources; we **CARE** for others through our prayers, outreach programs, and worship; we **GIVE** with our time, offerings, and talents; we are **GROWING**. Because our active membership is growing along with our desire to serve our community, we are proposing to move forward in new and meaningful ways.

We want to continue to welcome, invite, and encourage both our membership and our community. St. Paul has been blessed with a growing, active membership and stable giving, which has led to new and creative approaches to staffing and programming. Teams have been actively engaging the congregation in many different ways to determine the needs of our present and future ministries. We see opportunities for continued growth in our ministry moving forward through further expansion of our staff as well as updates and improvements to our facilities.

This brochure is intended to provide more information, and to engage you, our partners in ministry, in this process. Please take time to read this brochure. Please attend a Dialogue Session on November 3, 6 or 10. Times are listed on the cover page.

Equally important are the comments you write on the survey found on the last page of this brochure. Whether you are able to attend a Dialogue Session or not, please return the survey by Friday, November 15. You can drop off the survey in a box in the Cafe or Foyer, mail it to the church, or quickly respond to the online survey at www.stpaulvp.org.

We look forward to your input at a Dialogue Session and through your survey responses.

Your friends in Christ,
The PROJECT Forward Steering Team

Mark Freedlund	Bert Nuehring
Carol Freidheim	Alex Szerzinski
Doreen Fritz	James Szipszky
Gay Nass	Pastor Zachary Wagner



Why is St. Paul PROJECTing Forward?

Long range planning began in earnest starting in 2011, engaging multiple committees and church members. Through this process we have reaffirmed our commitment to our identity as a “neighborhood church” that is here to welcome and serve our members and surrounding community in Christ’s love. The demographics in and around St. Paul continue to change, and over 40 new active members were welcomed into our community in 2018 alone. As we continue to grow, we need to consider new approaches to meet the needs of our community in the future. Our current building and campus layout can make it difficult to carry out the ministries important to us due to space, safety and accessibility limitations.

Campus Plan

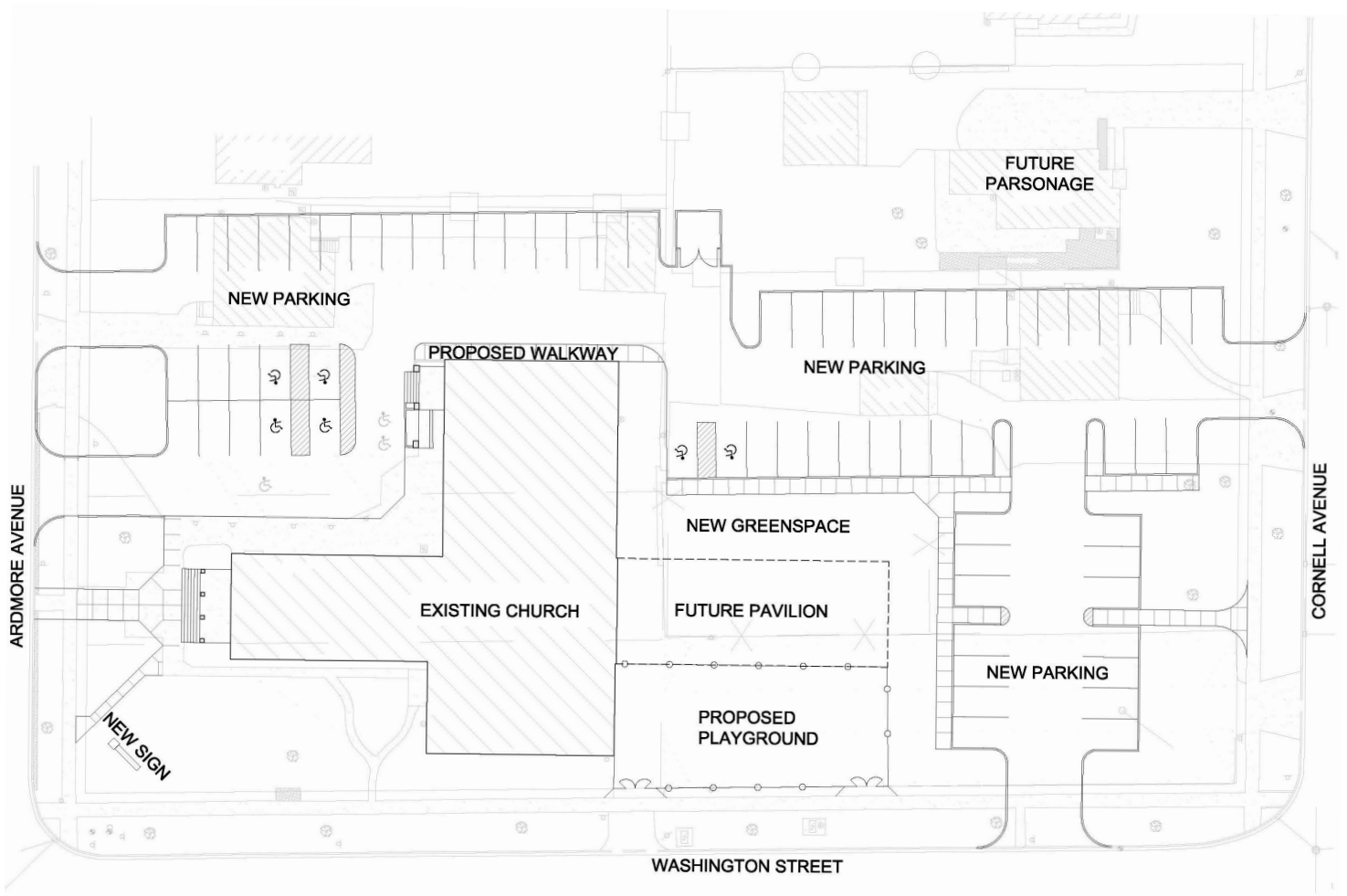

Our Preliminary Building Plans

Preliminary concepts will continue to evolve. Member input is welcomed.

In an effort to be good stewards, all plans involving our building will occur within its current footprint as a renovation of existing spaces.

Areas of focus:

Safety and Accessibility:

- New and reconfigured parking lots
- Additional parking spaces (including designated ADA spots)
- Improved pedestrian pathways
- New elevator replacing current lift

Welcoming Young Families:

- Relocate TotSpot (Nursery) to the main level
- More Godly Play classrooms
- Improvements to Day Care spaces
- Improved playground

Welcoming Everyone:

- Larger Cafe and improved meeting spaces
- Additional restrooms on main level
- Greater flexibility in layout of sanctuary
- Reconfigured office spaces

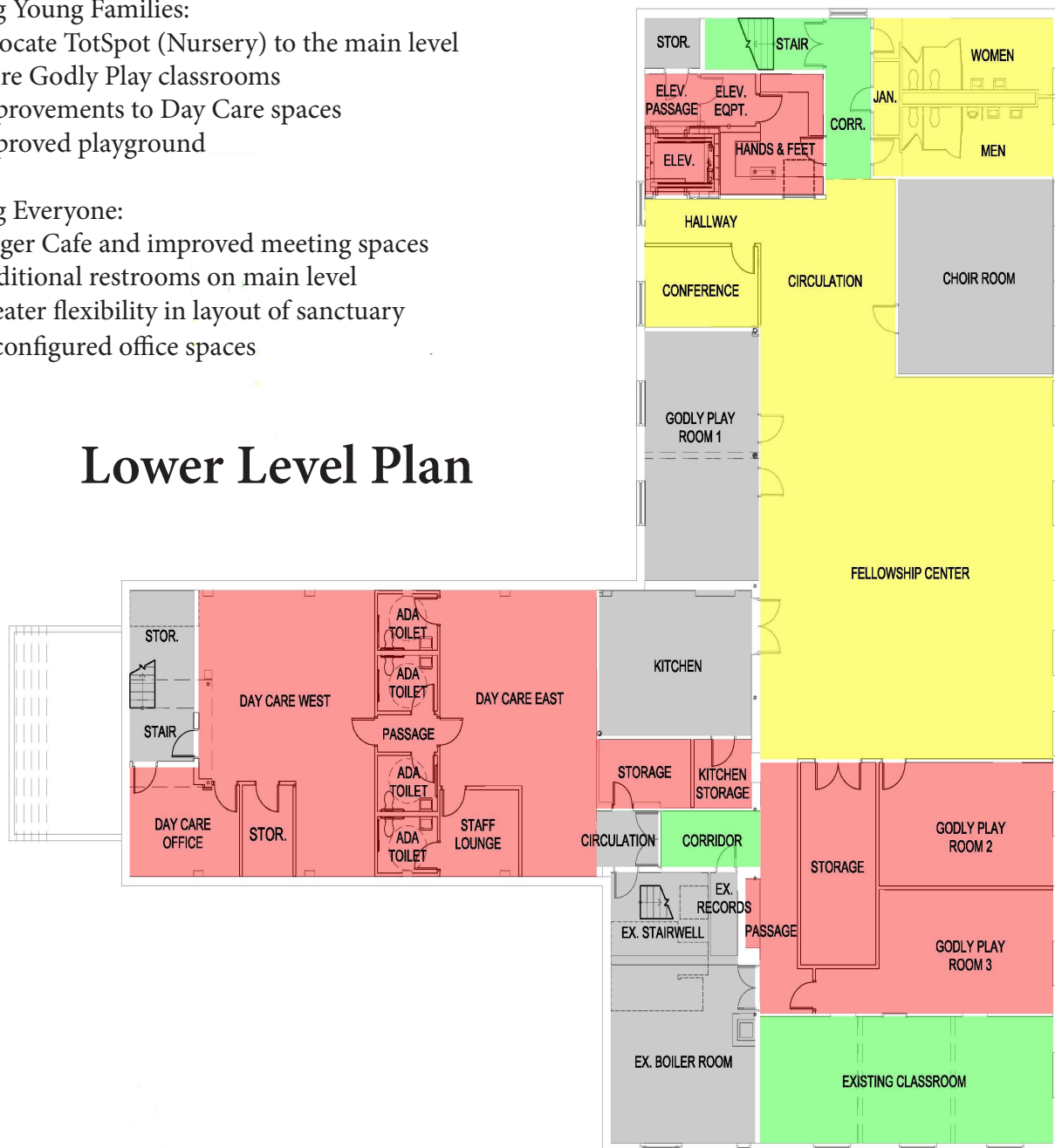

Lower Level Plan



Main Level Plan

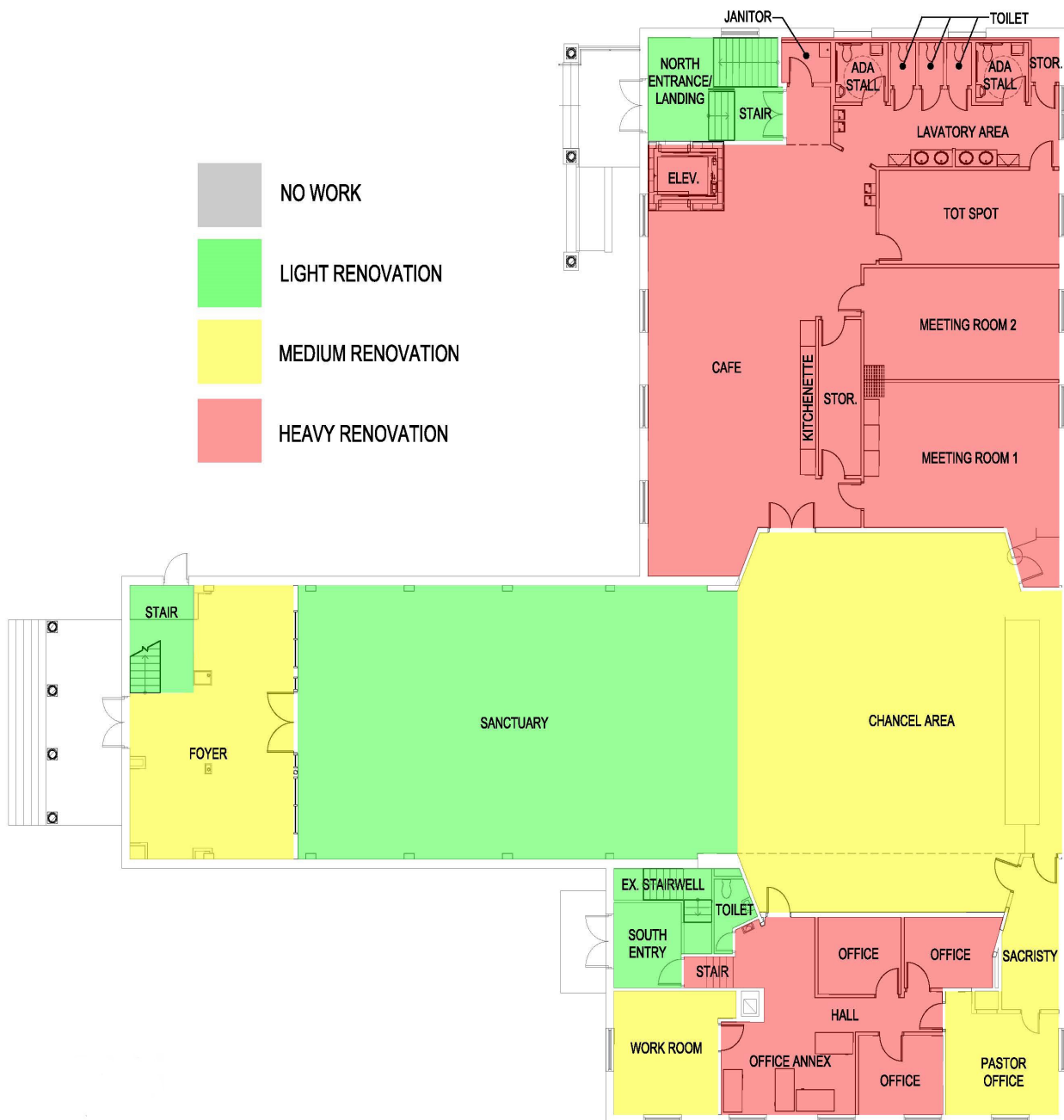



Potential Building Project Funding

The proposed building renovation plans and site work are conservatively estimated to cost \$3 to \$3.5 million. This is a very rough estimate for all of the work proposed, which will guide us over the course of the coming years. Total work and associated costs of this initial phase may be significantly altered and will be prioritized according to need, efficiency and impact on overall ministry. With good stewardship practices, we set aside \$140,000 from our Capital Projects Fund for this building project. We are planning on conducting a capital campaign in the coming months. Raising the project funds would be a worthy challenge for a congregation our size, stretching all of us in our generosity. We are prepared to enlist the help of The James Company, a stewardship consulting firm, to assist us. The James Company has successfully helped many ELCA congregations with their capital campaigns.

By spring 2020, after the three-year capital campaign pledges are received, we will have a better understanding of the total funds we can expect from our members. We would also welcome offers of in-kind services and construction skills to help reduce the cost of our building project. The response of our members to the capital campaign will be a significant factor in determining how much of the proposed concept can be accomplished, and in what phases the work will be divided. We are also open to the possibility of borrowing project funds, but wish to keep this to a minimum. It is possible that we could begin our building projects as early as summer 2020.

Property Acquisition Funding

We recently acquired property at 536 S. Cornell, adjacent to our current parsonage. This purchase provided increased flexibility for our site planning as reflected in the designs included in this brochure. The purchase price of \$220,000 was primarily funded by our cash reserves. Our goal is to fund the building project and rebuild our cash reserves through our proposed capital campaign.

Potential Ministry Funding

As we grow, we anticipate opportunities to expand our ministries in creative and exciting ways. By tithing 10% of our capital campaign gifts for our ministries, we can ensure we have the seed funding needed to staff and kickstart new opportunities to grow, care, give and share in Jesus' name.

Three Things We Ask You To Do

1. **Attend one of the Dialogue Sessions on November 3, 6 or 10.**
2. **By November 15, complete the online survey found at www.stpaulvp.org. or return the enclosed survey to a survey box located in the Cafe or Foyer.**
3. **Continue to pray for God's blessings on our planning process as we prepare for the future...all to the Glory of God.**

We Need Your Feedback

Your feedback is important as we strive to make the best plans to support the mission of St. Paul. You may prefer to fill out this survey online by going to the ProJECT Forward tab at www.stpaulvp.org.

1. List the things you like best about these preliminary building plans.

2. Share any questions, suggestions, or concerns you have regarding these preliminary building plans.

3. I/We would financially support a capital campaign to fund these preliminary building plans:

Yes

No

Uncertain

Comments: _____

Please print your name(s): _____

You can drop off the survey in a box in the Cafe or Foyer, mail it to the church, or quickly respond to the online survey at www.stpaulvp.org. **Please respond by November 15.**

St. Paul Lutheran Church
545 Ardmore Ave.
Villa Park, IL 60181

RETURN SERVICE REQUESTED

Non-Profit Org.
U.S. Postage
PAID
Lombard, IL
Permit #222



St. Paul Preliminary Building Plans and Proposed Capital Campaign

Important time dated material enclosed.
Please read immediately. Thank you.